

OWNERS:

DAVID & PEGGY ODEGARD
(PARCEL 21622 & 21623)

WILLIAM R. & NANCY A. SMITH
(PARCEL 21623 & 21624)

SURVEYOR:

ENCOMPASS ENGINEERING & SURVEYING
407 SWIFTWATER BLVD
CLE ELUM WA 98922
509-674-7433

KITTITAS COUNTY PARCEL AND (MAP NUMBER):

21622 (20-14-24050-0409)
21623 (20-14-24050-0410)
21624 (20-14-24050-0411)

ZONE:

MASTER PLANNED RESORT

LINE TABLE		
LINE #	DIRECTION	DISTANCE
L1	S 72°25'00" E	51.02'
L2	S 75°59'47" E	35.71'
L3	S 84°57'48" E	56.45'
L4	N 77°54'00" E	46.98'
L5	N 62°20'28" E	46.98'
L6	S 68°17'20" E	68.56'
L7	S 84°54'25" W	19.48'
L8	S 51°03'48" W	24.39'

INDEX LOCATION
SEC. 24 T. 20 N.R. 14 E.W.M.

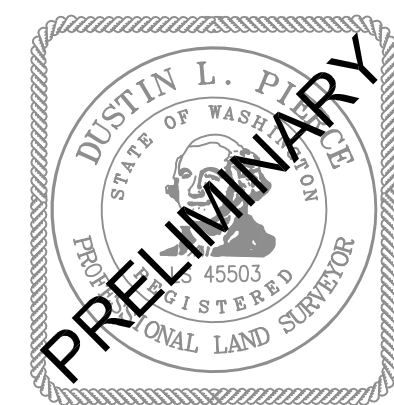
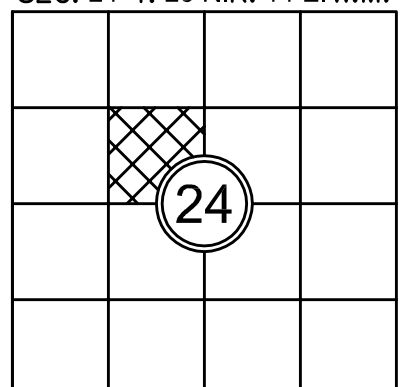

LEGEND

- ⊕ FOUND MONUMENT AS NOTED
- IR FOUND 5/8" REBAR, NO CAP
- FOUND 5/8" REBAR & CAP, LS 29294/29281, UNLESS OTHERWISE NOTED
- SET 5/8" REBAR & CAP, LS 45503

Encompass
ENGINEERING & SURVEYING

Western Washington Division
165 NE Juniper Street, Suite 201 • Issaquah, WA 98027 • Phone: (425) 392-0250
Eastern Washington Division
407 Swiftwater Blvd. • Cle Elum, WA 98922 • Phone: (509) 674-7433

PRELIMINARY BOUNDARY LINE ADJUSTMENT

PREPARED FOR
BILL & NANCY SMITH - DAVID & PEGGY ODEGARD
A PORTION OF THE SE 1/4 OF THE NW 1/4 OF SECTION 24,
TOWNSHIP 20 NORTH, RANGE 14 EAST, W.M.

KITTITAS COUNTY		WASHINGTON	
DWN BY	DATE	JOB NO.	
D.L.P./G.W.	09/2023	23050	
CHKD BY	SCALE	SHEET	
D.L.P.	1" = 40'	1 OF 2	